

# Paving Memories

## Help Hancock County Fairgrounds pave the Old Mill Stream Memorial Park

Show your support by donating a personal engraved brick paver(s), which will be used to pave the memorial park. There is no limit on the number of pavers that you can purchase.

- Brick Pavers are available in two sizes - 4" x 8" or 8"x 8"
- Each brick paver can be engraved with your name, a company name or a dedication.
- All funds raised through this will go towards the completion of this project and future beautification projects.



### How To Buy A Paver

Complete the order form on the reverse side and send along with your Donation to:

**Hancock County Agricultural Society**  
**P.O. Box 148**  
**Findlay, Ohio 45839**

Make Checks payable to: *Hancock Co Ag Society*

For additional info contact our office at 419-429-7344 or email- [srfair@hancockfairgrounds.org](mailto:srfair@hancockfairgrounds.org)

### Old Mill Stream Memorial Park

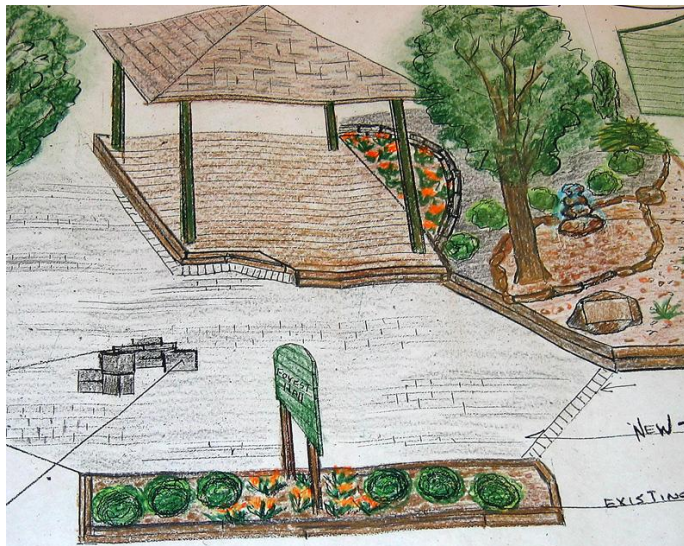

**Order Form on Reverse Side**

Hancock County Agricultural Society

Paving Memories Order Form

Name \_\_\_\_\_

Business or Organization Name \_\_\_\_\_

Address \_\_\_\_\_

City \_\_\_\_\_ State \_\_\_\_\_ Zip \_\_\_\_\_

Phone \_\_\_\_\_ Email address \_\_\_\_\_

Quantity of Pavers:

\_\_\_\_\_ x \$50 (4" x 8" brick paver) = \_\_\_\_\_

\_\_\_\_\_ x \$75 (8" x 8" brick paver) = \_\_\_\_\_

Donation ONLY \_\_\_\_\_ = \_\_\_\_\_

Total Donation = \_\_\_\_\_

-----  
**Fill in blanks with your name, company name or dedication.**

4" x 8" Engraved Paver \$50 – 3 Lines, 14 Characters including spaces (No punctuation)

8" x 8" Engraved Paver \$75 – 6 Lines, 14 Characters including spaces (No punctuation)

Please double check your spelling submitted before sending in.  
For more than one order of either size, please make additional copies and attach together. Tk You!